

NEHG-HARBOR-4260

DROP-IN

Key Attributes

Shape: RECTANGULAR

Material: ACRYLIC

Soaker Weight: 140 lbs

Jetted Weight: 170 lbs

Average Fill Capacity*: 70-80 gal

*Estimated with occupant inside. May vary based on occupant's volume

Required Electrical: Service 110v

Air Bath: 1x 15 amp GFCI

Key Measurements (inches)

Overall Outer: 59.875 L x 41.5 W x 23 H

Overall Interior: 51 L x 33.125 W x 20 H

Interior Base: 40 L x 29.5 W

Soaking Depth: 16

Drain to Side Wall: 20.75

Drain to Nearest Wall: 9

Lip Size: 2

Deck Space: 4

Compliance: Uniform Plumbing Code UPC®; International Plumbing Code IPC®; ADA

Standards: ASME A112.19.15; CSA C22.2 No. 218.2-15; UL 1795, 5th Edition Issued September 02, 2016 including revisions through August 25, 2017

Certified: UPC, EGS

It is vital that tub is completely level for drain to work properly.

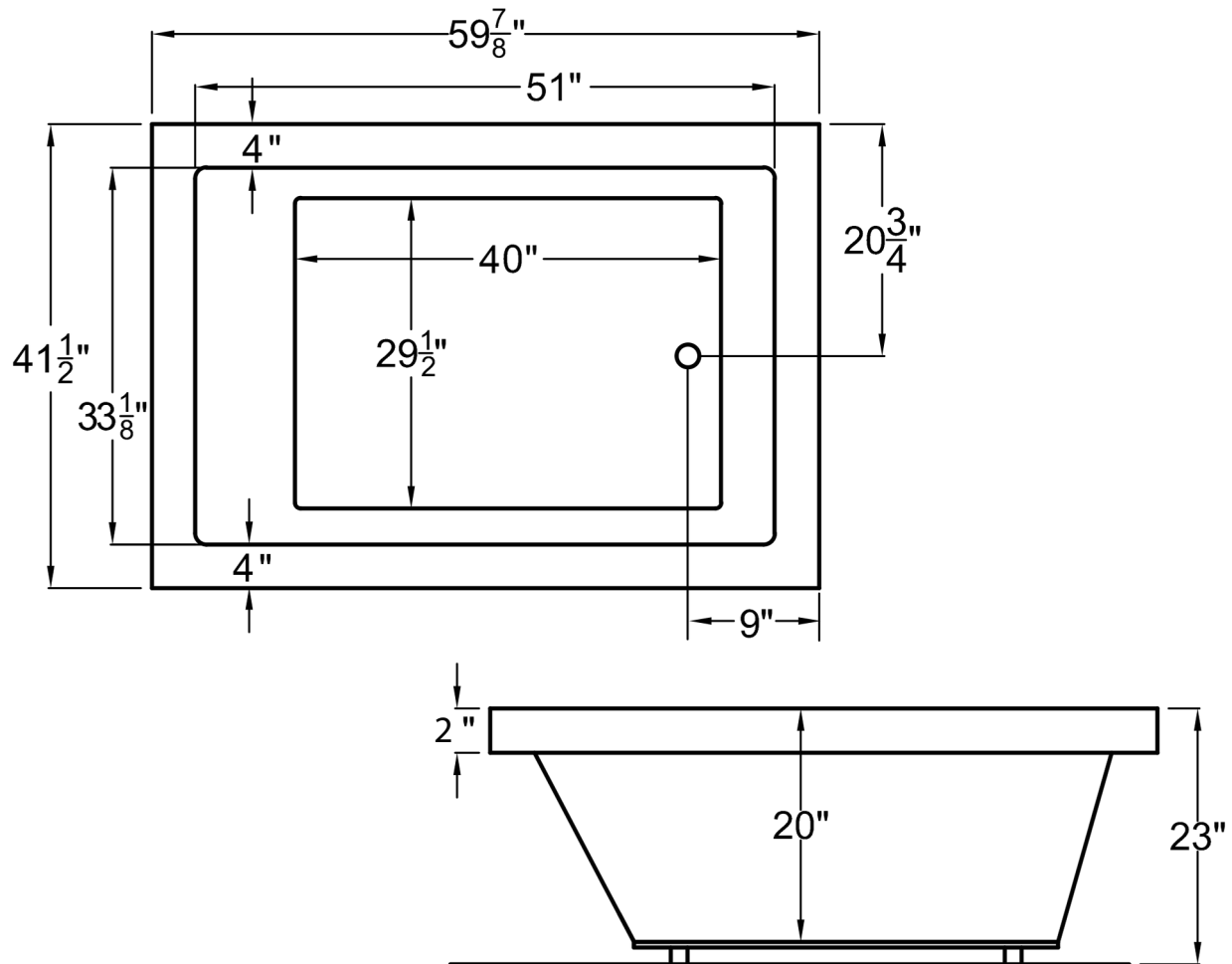

- **IMPORTANT! TEST THE TUB'S DRAIN AND JETS (if any) BEFORE PERMANENT INSTALLATION!**
- **INSPECT THE TUB WHEN RECEIVED!** Report any damages or missing parts within 5 business days of delivery date.
- Before ordering or installing, please consider future access to equipment.
- **Please measure tub on-site before building tub surrounding!**
- Jet, pump & blower locations are predetermined and cannot be changed.
- Tub door must remain closed when not in use.

- Please note that installer(s) must be certified or warranty will be voided.
- Measurements are subject to a +/- .5" variance and subject to change without notice. Measurements here in supersede all other published specs prior to publication date shown below.
- Inline heater (if included) is designed to maintain water temperature during operation. It will not heat cold water to desired bathing temperature.